

 Trust



[www.trust.com/23291/faq](http://www.trust.com/23291/faq)



**YULA** | WIRED GAMEPAD

1

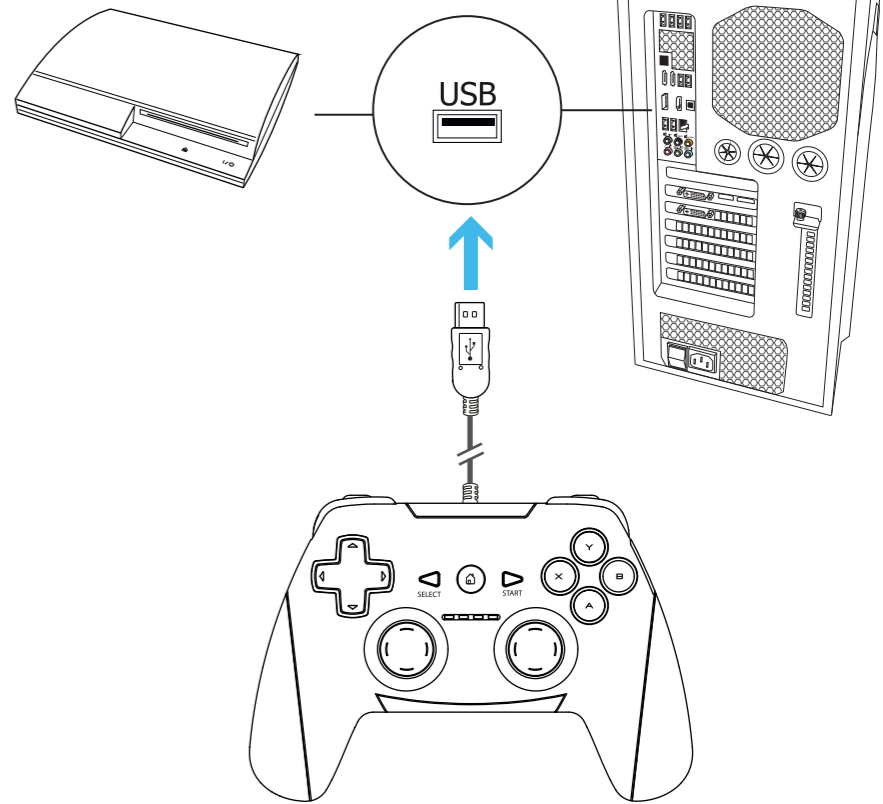

2

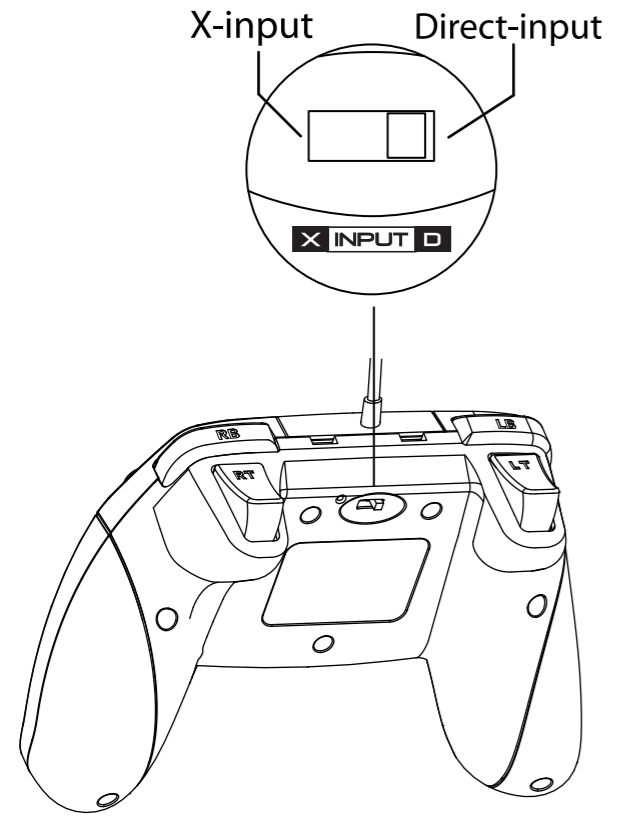

3

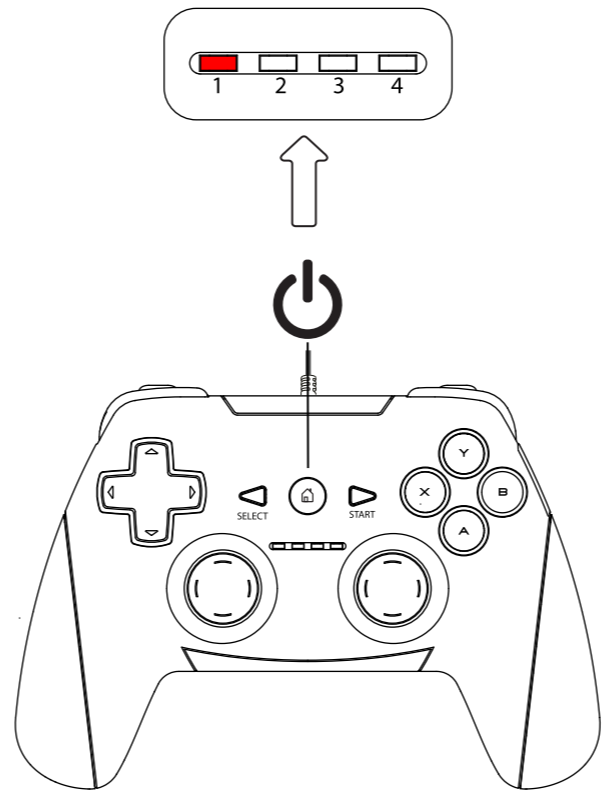

PC

A series of screenshots illustrating the steps to access game controller settings on a PC. The steps are numbered 1 through 5:

- Step 1:** Shows the Windows Start menu icon with a gear icon for settings.
- Step 2:** Shows the 'Control panel' window.
- Step 3:** Shows the 'Devices and Printers' window.
- Step 4:** Shows a context menu for a game controller icon with 'Game controller settings' highlighted.
- Step 5:** Shows the 'Game Controllers' window with 'USB Game Pad' selected in the list and the 'Properties' button highlighted.

Below the navigation steps, two screenshots show the configuration options for the 'USB Game Pad':

- Game Controllers window:** Shows a table of installed controllers. The 'USB Game Pad' is listed with a status of 'OK'. The 'Properties' button is highlighted.

Controller	Status
USB Game Pad	OK

- USB Game Pad properties window:** Shows calibration options for the controller's axes and buttons. The 'X Axis / Y Axis' section has a '+' button. The 'Buttons' section shows a grid of 12 buttons. The 'Point of View Hat' section shows a circular hat button.