



RAZER KITSUNE

MASTER GUIDE

Embrace a new fighting game meta with the **Razer Kitsune**—an all-button optical arcade controller that surpasses traditional fight sticks. With an evolved precise quad movement button layout and lightning-fast optical switches, eliminate input errors from your game with the perfect competitive fighting companion for PS5™ and PC.

CONTENTS

1. WHAT'S INSIDE 3

2. WHAT'S NEEDED 4

3. LET'S GET YOU COVERED 5

4. SETTING UP YOUR RAZER KITSUNE..... 6

5. USING YOUR ARCADE CONTROLLER 9

6. SAFETY AND MAINTENANCE 14

7. LEGALESE..... 16

1. WHAT'S INSIDE

- Razer Kitsune

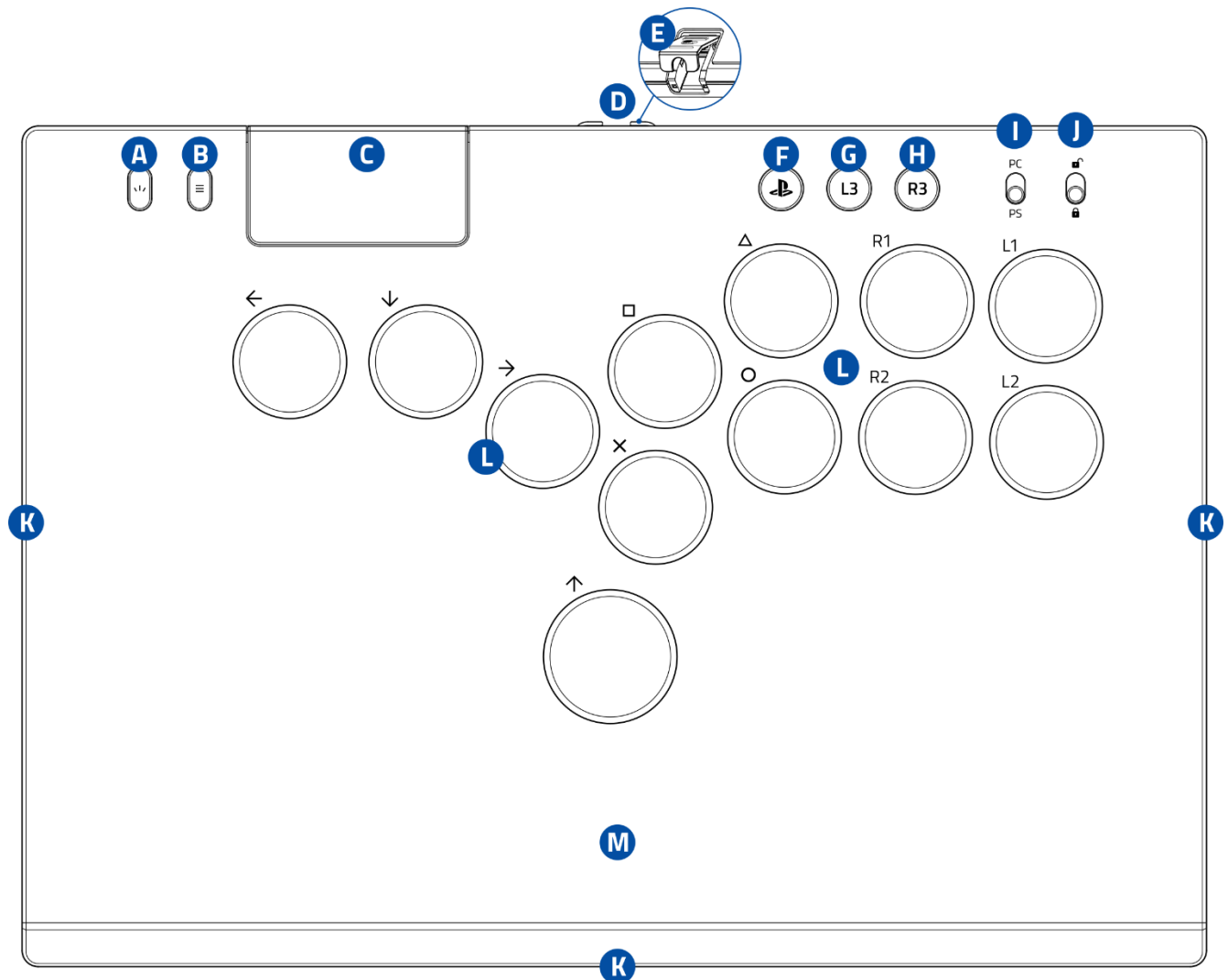

- A.** Create button
- B.** Options button
- C.** Touch pad, Touch pad button
- D.** USB Type C port
- E.** Cable security clasp
- F.** PS button
- G.** L3 button
- H.** R3 button
- I.** Arcade controller mode switch (PC / PS)
- J.** Tournament lock switch
- K.** Arcade controller lighting Powered by Razer Chroma™ RGB
- L.** Razer™ Low-profile linear optical pushbuttons
- M.** Removable aluminium top plate

- USB Type C to USB Type A cable

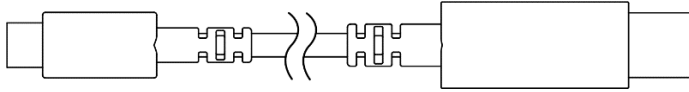

- Important Product Information Guide

2. WHAT'S NEEDED

- PS5™ console or PC (Windows® 10 64-bit or higher)*
- USB Type A port

**Razer has validated the operation between this arcade controller and the PlayStation®5 console. PC compatibility not tested nor endorsed by Sony Interactive Entertainment.*

3. LET'S GET YOU COVERED



Register your product and score exclusive benefits

razerid.razer.com/warranty

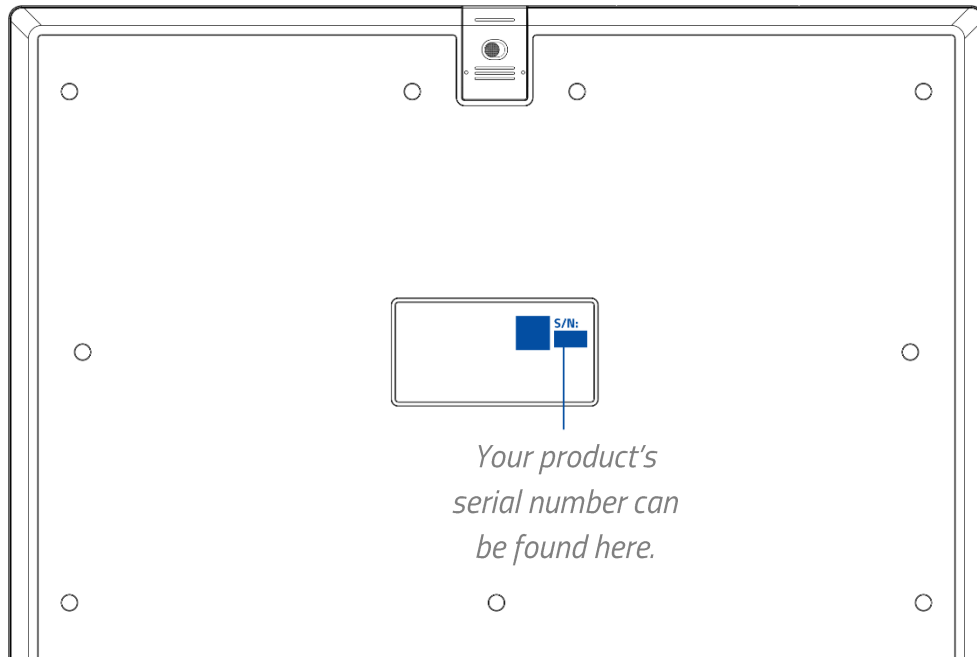

*Your product's
serial number can
be found here.*

4. SETTING UP YOUR RAZER KITSUNE

CONNECTING AND LOCKING THE CABLE

1. Unlock the cable security clasp, and slide it outwards.

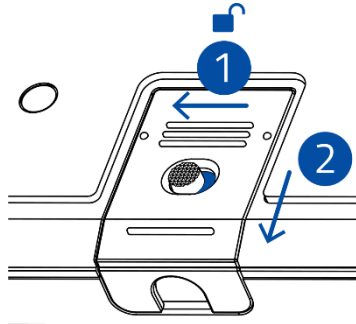

2. Lift the security clasp and connect the USB Type C to USB Type A cable to the USB Type C port of the arcade controller.

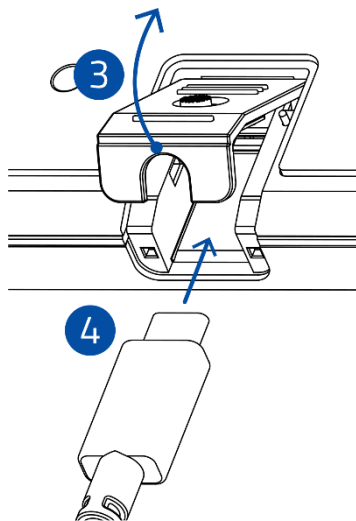

3. Push down the cable security clasp, slide it inwards, and lock it in place.

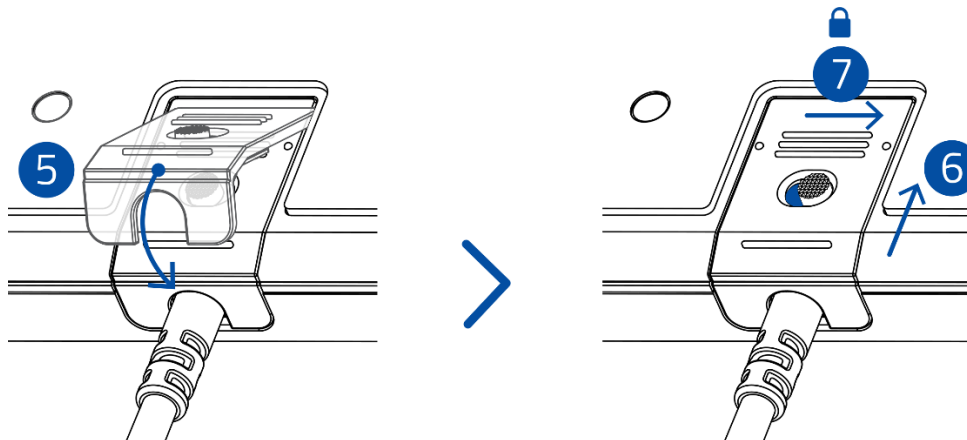

CONNECTING THE ARCADE CONTROLLER

1. Set the arcade controller mode according to the intended device.

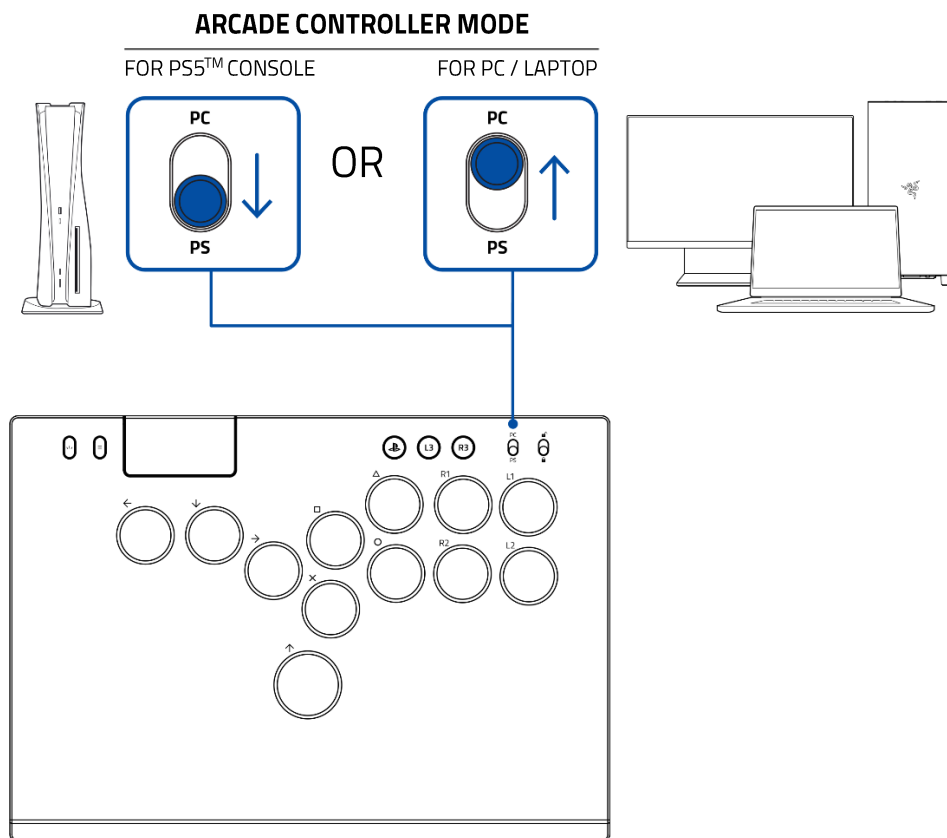

2. Plug the controller into the PS5™ console or PC using the USB Type A to USB Type C cable.

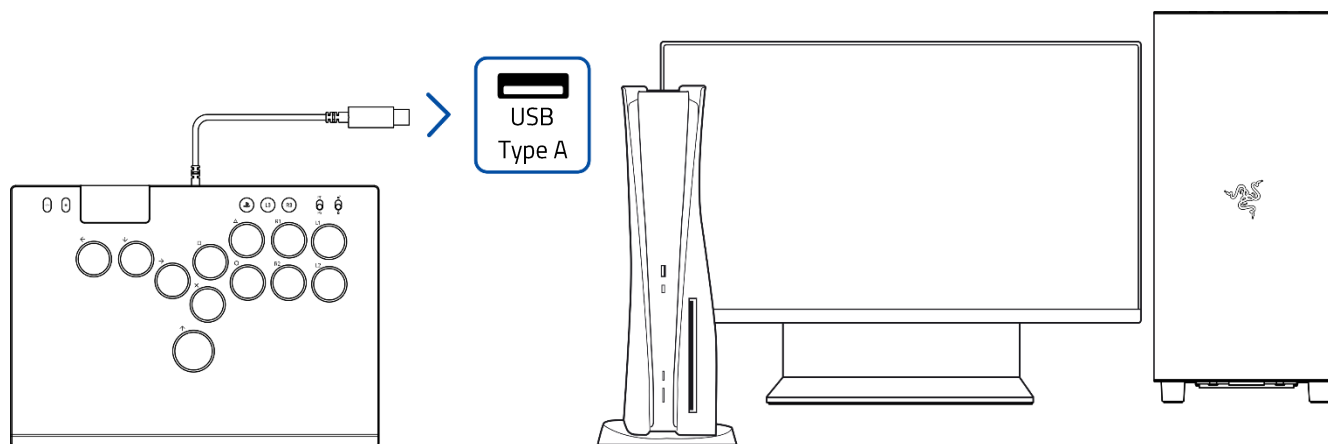

For safety purposes and to easily unplug the arcade controller when not in use, it's recommended to plug it into the USB port at the front of the PS5™ console.

3. Press the PS button to begin using the arcade controller.

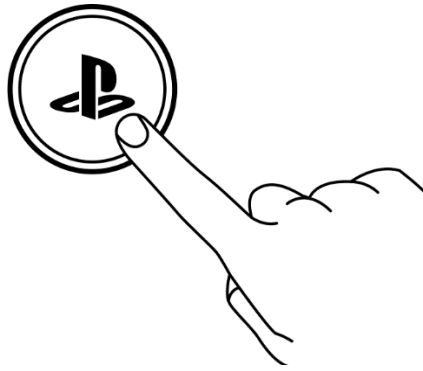

5. USING YOUR ARCADE CONTROLLER

USING THE TOURNAMENT LOCK SWITCH

Set the tournament lock switch to the locked (🔒) state to disable the Create, PS, and Options buttons, and unlock (🔓) to use them again.

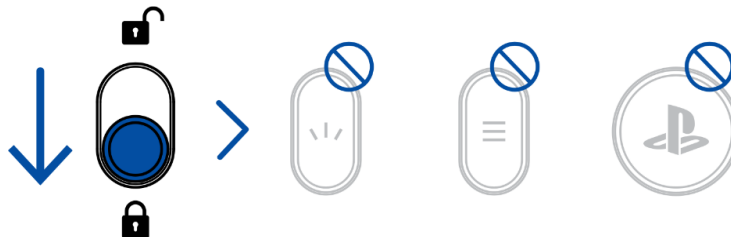

i When the controller mode switch is set to PC, the touch pad is also disabled if the tournament lock switch is in locked (🔒) state.

CUSTOMIZING THE ARCADE CONTROLLER LIGHTING

Customizing the lighting effect

To cycle through available lighting effects:

1. Set the tournament lock switch to the locked (🔒) state.

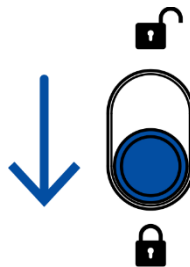

2. Press and hold the Create button, then press the arrow up button to cycle through available lighting effects.

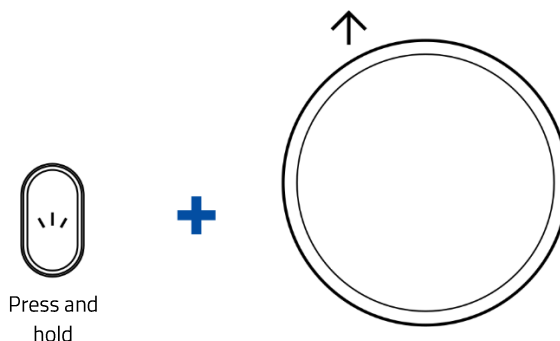

OFF > STATIC > SPECTRUM CYCLE (DEFAULT) > WAVE > BREATHING > REACTIVE

To switch between colors in Static or Breathing effects:

1. Set the tournament lock switch to the locked (🔒) state.

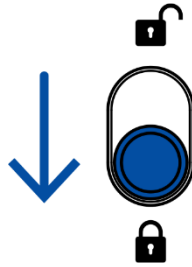

2. With the Static or Breathing effect active, press and hold the Create button and then press the R1 or R2 buttons to cycle between the available colors of the active effect.

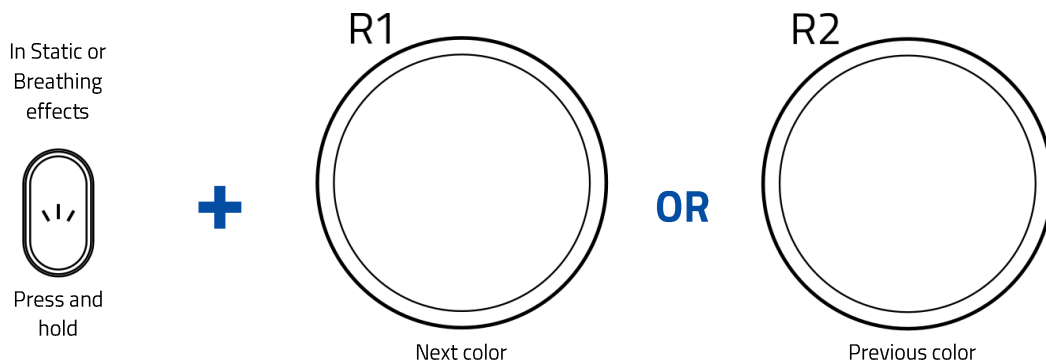

**GREEN (DEFAULT) > BLUE > YELLOW > PURPLE > CYAN > ORANGE
> WHITE > RED**

To shift between animation speeds in Spectrum Cycling, Wave, or Breathing effects:

1. Set the tournament lock switch to the locked (🔒) state.

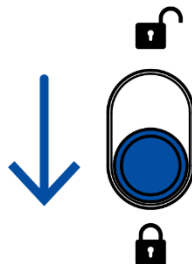

2. With Spectrum cycling, Wave, or Breathing effect active, press and hold the Create button and then press the L1 button to adjust the animation speed of the active effect.

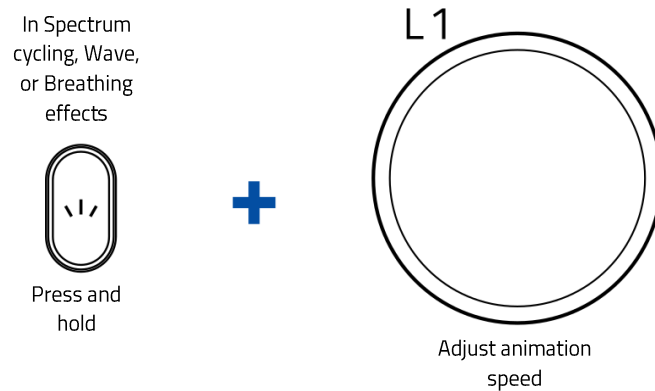

Adjusting the brightness level

1. Set the tournament lock switch to the locked (🔒) state.

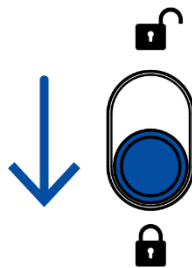

2. Press and hold the Create button and then press the Δ or \bigcirc buttons to increase or decrease the brightness of the arcade controller's lighting.

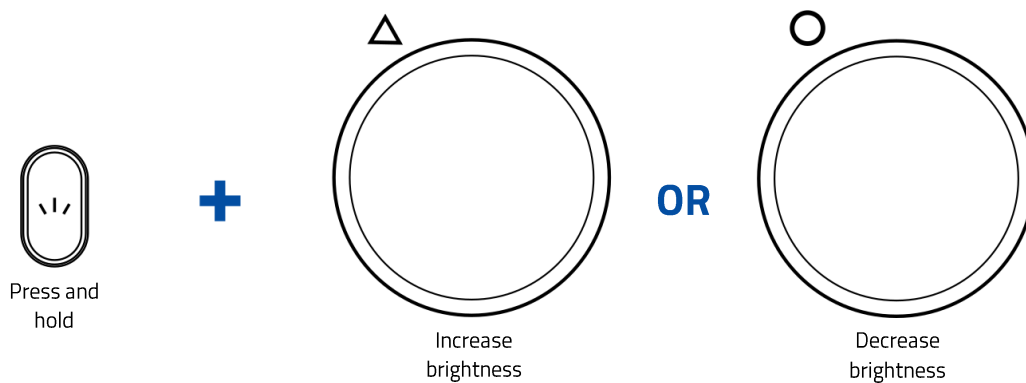

USING YOUR PREFERRED CUSTOM TOP PLATE

i *Custom top plates are not included and/or are sold separately. Only use custom plates made and/or approved by Razer.*

1. Detach the rubber covers and remove the screws at the bottom of the arcade controller using a Philips screwdriver (not included).

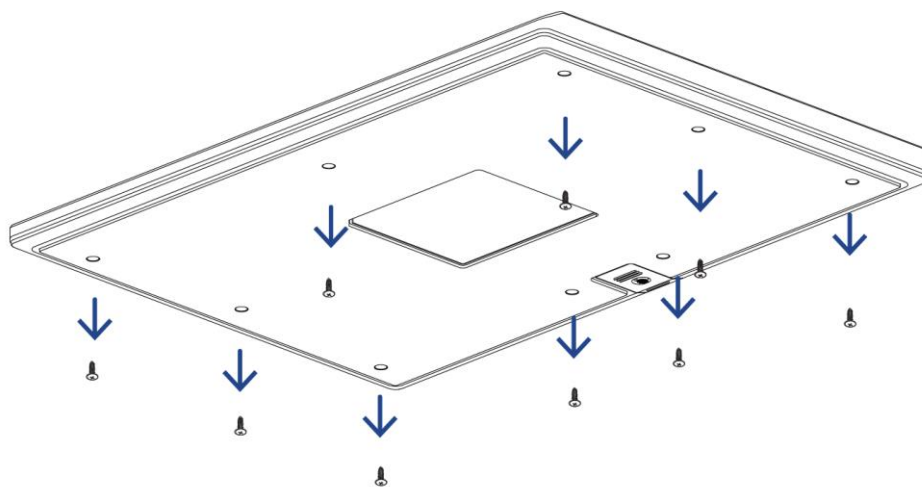

2. Remove the aluminum top plate.

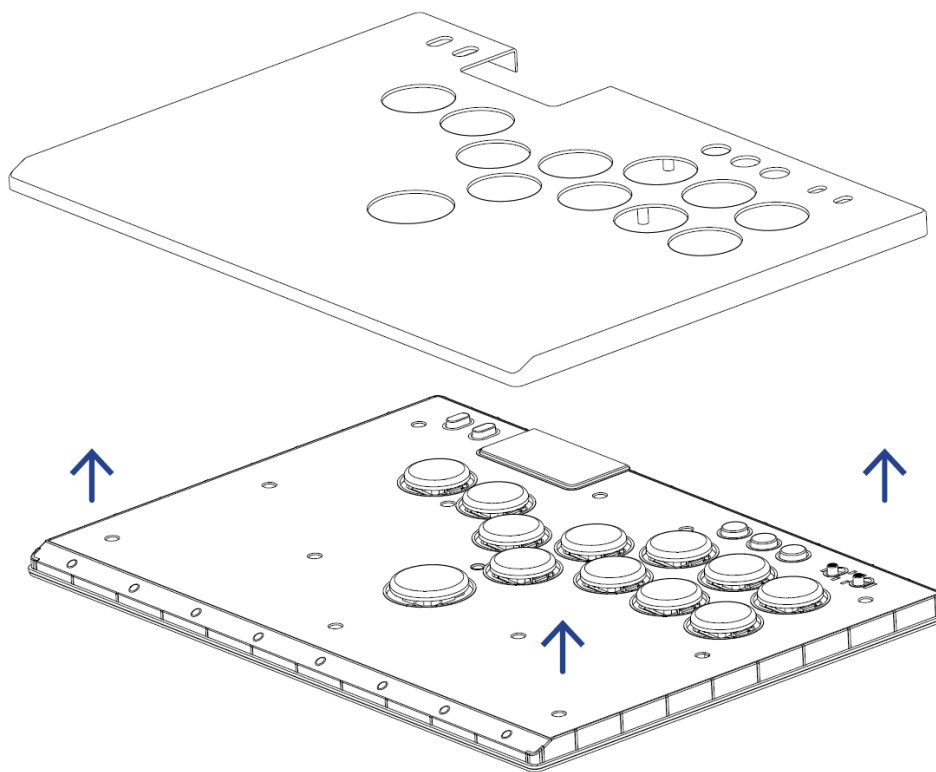

3. Place your custom top plate onto the arcade controller.

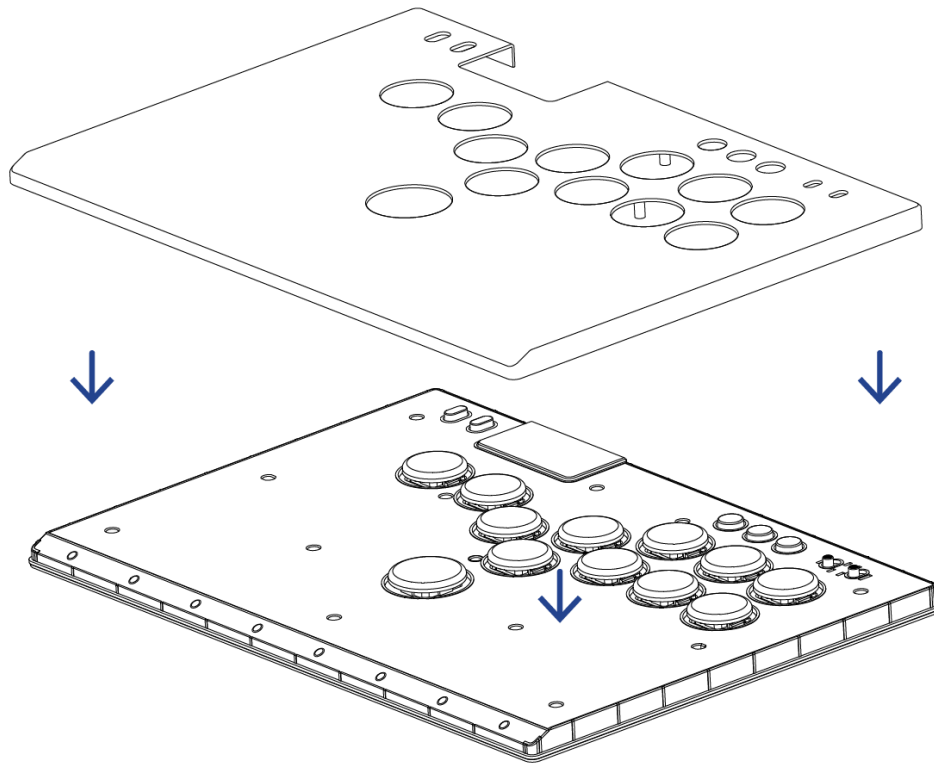

4. Reattach the bottom screws and rubber covers.

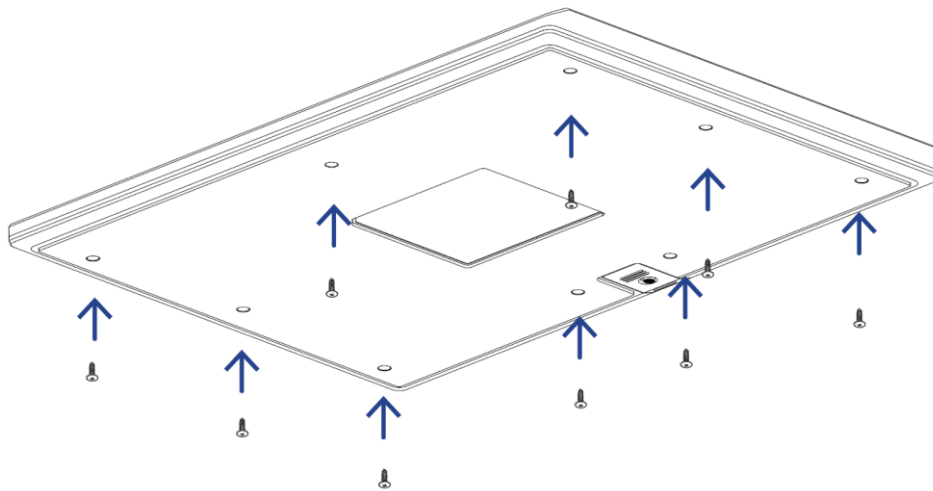

6. SAFETY AND MAINTENANCE

SAFETY GUIDELINES

To achieve maximum safety while using your Razer Kitsune, we suggest that you adopt the following guidelines:

Unplug the arcade controller and organize its cord when not in use. Make sure to keep the arcade controller and its parts out of the reach of small children to avoid accidents and/or injuries.

Don't place items on top of the arcade controller.

Should you have trouble operating the device properly and troubleshooting does not work, unplug the device and contact the Razer hotline or go to support.razer.com for assistance.

Keep the device away from liquid, humidity or moisture. Operate the device only within the specific temperature range of 0°C (32°F) to 40°C (104°F). Should the temperature exceed this range, unplug and/or switch off the device to let the temperature stabilize to an optimal level.

COMFORT

Research has shown that long periods of repetitive motion, improper positioning of your computer peripherals, incorrect body position, and poor habits may be associated with physical discomfort and injury to nerves, tendons, and muscles. Below are some guidelines to avoid injury and ensure optimum comfort while using your Razer Kitsune.

1. Position the arcade controller directly in front of you and within easy reach.
2. Adjust the height of your chair and/or table so that the Razer Kitsune is at or below elbow height.
3. Keep your feet well supported, posture straight, and your shoulders relaxed.
4. During gameplay, relax your wrist and keep it straight. If you do the same tasks with your hands repeatedly, try not to bend, extend or twist your hands for long periods.
5. Don't sit in the same position all day. Get up, step away from your desk and do exercises to stretch your arms, shoulders, neck and legs.

If you should experience any physical discomfort while using your Razer Kitsune, such as pain, numbness, or tingling in your hands, wrists, elbows, shoulders, neck or back, please consult a qualified medical doctor immediately.

MAINTENANCE AND USE

The Razer Kitsune requires minimum maintenance to keep it in optimum condition. Once a month, we recommend you clean it using a soft cloth or cotton swab to prevent dirt buildup. Don't use soap or harsh cleaning agents.

7. LEGALESE

COPYRIGHT AND INTELLECTUAL PROPERTY INFORMATION

©2025 Razer Inc. All rights reserved. Razer, the triple-headed snake logo, Razer logo, "For Gamers. By Gamers.", and "Powered by Razer Chroma" logo are trademarks or registered trademarks of Razer Inc. and/or affiliated companies in the United States or other countries.

"", "PlayStation", and "PS5" are registered trademarks of Sony Interactive Entertainment Inc. All other trademarks are the property of their respective owners. Manufactured and distributed under license from Sony Interactive Entertainment.

Windows and the Windows logo are trademarks of the Microsoft group of companies.

Razer Inc. ("Razer") may have copyright, trademarks, trade secrets, patents, patent applications, or other intellectual property rights (whether registered or unregistered) concerning the product in this guide. Furnishing of this guide does not give you a license to any such copyright, trademark, patent or other intellectual property right. The Razer Kitsune (the "Product") may differ from pictures whether on packaging or otherwise. Razer assumes no responsibility for such differences or for any errors that may appear. Information contained herein is subject to change without notice.

LIMITED PRODUCT WARRANTY

For the latest and current terms of the Limited Product Warranty, please visit [razer.com/warranty](https://www.razer.com/warranty).

LIMITATION OF LIABILITY

Razer shall in no event be liable for any lost profits, loss of information or data, special, incidental, indirect, punitive or consequential or incidental damages, arising in any way out of distribution of, sale of, resale of, use of, or inability to use the Product. In no event shall Razer's liability exceed the retail purchase price of the Product.

GENERAL

These terms shall be governed by and construed under the laws of the jurisdiction in which the Product was purchased. If any term herein is held to be invalid or unenforceable, then such term (in so far as it is invalid or unenforceable) shall be given no effect and deemed to be excluded without invalidating any of the remaining terms. Razer reserves the right to amend any term at any time without notice.